

União reta engate rápido

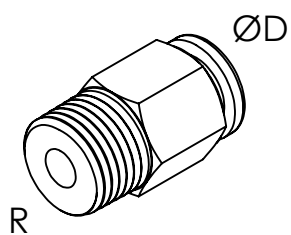

Código	R	ØD
UR04-M5	M5	04
UR04-18	1/8"	04
UR06-M5	M5	06
UR06-18	1/8"	06
UR06-14	1/4"	06
UR08-18	1/8"	08
UR08-14	1/4"	08

União joelho engate rápido

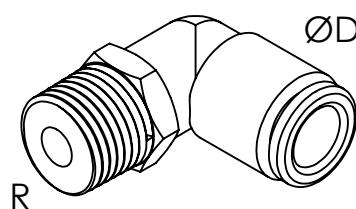

Código	R	ØD
UJ04-M5	M5	04
UJ04-18	1/8"	04
UJ06-M5	M5	06
UJ06-18	1/8"	06
UJ06-14	1/4"	06
UJ08-18	1/8"	08
UJ08-14	1/4"	08

União tubo engate rápido

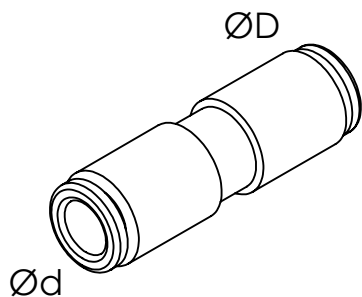

Código	Ød	ØD
UT04	04	04
UT06	06	06
UT08	08	08
UT10	10	10
UT12	12	12
UT16	16	16

Redução tubo engate rápido

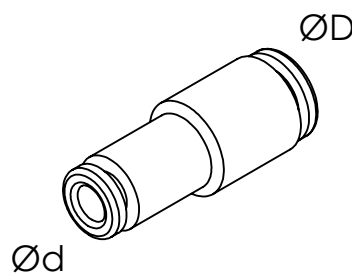

Código	Ød	ØD
RT06-04	04	06
RT08-06	06	08
RT10-08	08	10
RT12-10	10	12
RT16-12	12	16

Redução conexão para tubo

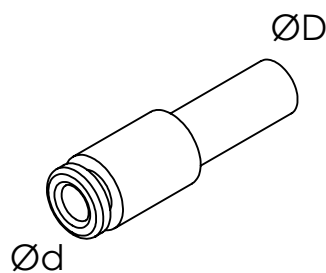

Código	Ød	ØD
RC06-04	04	06
RC08-06	06	08
RC10-08	08	10
RC12-10	10	12
RC16-12	12	16

Corpo roscado engate rápido

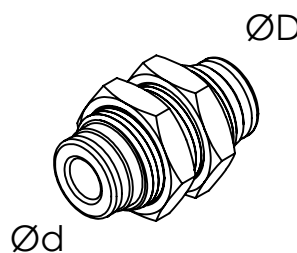

Código	Ød	ØD
CR04-04	04	04
CR06-06	06	06
CR08-08	08	08
CR10-10	10	10
CR12-12	12	12
CR16-16	16	16

Tampão para conexão engate rápido

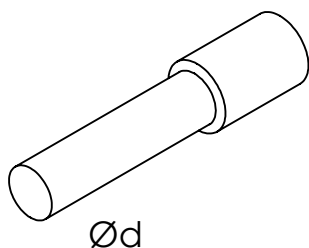

Código	Ød
TC04	04
TC06	06
TC08	08
TC10	10
TC12	12
TC16	16

Tampão para tubo engate rápido

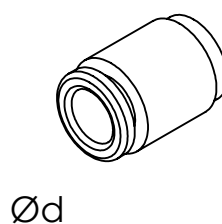

Código	Ød
TT04	04
TT06	06
TT08	08
TT10	10
TT12	12
TT16	16

União T engate rápido

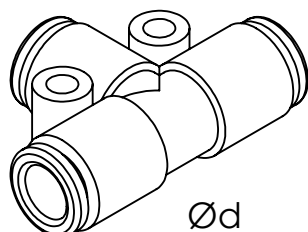

Código	Ød
T04	04
T06	06
T08	08
T10	10
T12	12
T16	16

União Y engate rápido

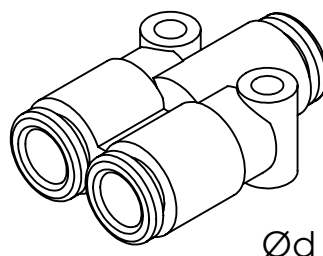

Código	Ød
Y04	04
Y06	06
Y08	08
Y10	10
Y12	12
Y16	16

União T redução engate rapido

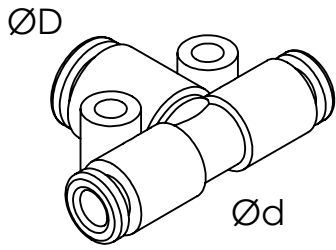

Código	dØ	ØD
TR06-04	04	06
TR08-06	06	08
TR10-18	08	10
UR12-10	10	12

União Y redução engate rapido

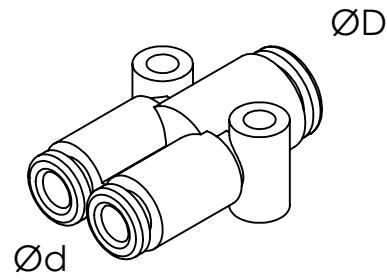

Código	dØ	ØD
YR06-04	04	06
YR08-06	06	08
YR10-08	08	10
YR12-10	10	12

Tampão sextavado

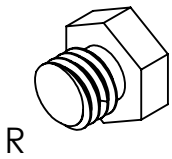

Código	R
TSM5	M5
TSM4	M4
TSM3	M3

União sextavada

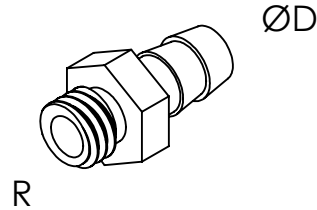

Código	R	ØD
US04-M5	M5	04
US06-M5	M5	06

Tampão allen

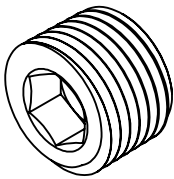

Código	R
TA18	1/8"
TA14	1/4"
TA38	3/8"
TA12	1/2"

Niple redução macho

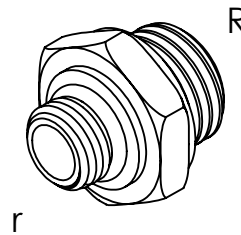

Código	r	R
NRM18-14	1/8"	1/4"
NRM14-38	1/4"	3/8"
NRM38-12	3/8"	1/2"

Niple macho

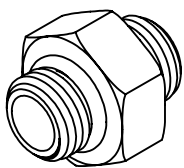

Código	R
NM18	1/8"
NM14	1/4"
NM38	3/8"
NM12	1/2"

Luva fêmea

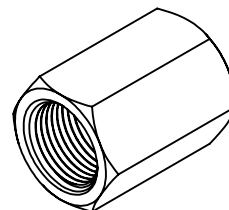

Código	R
LF18	1/8"
LF14	1/4"
LF38	3/8"
LF12	1/2"

Manifold Tubular 1/8" com 1 linha

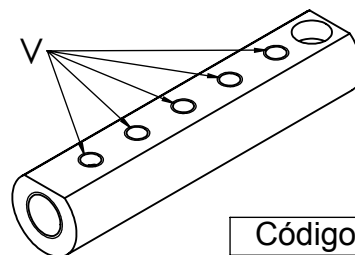
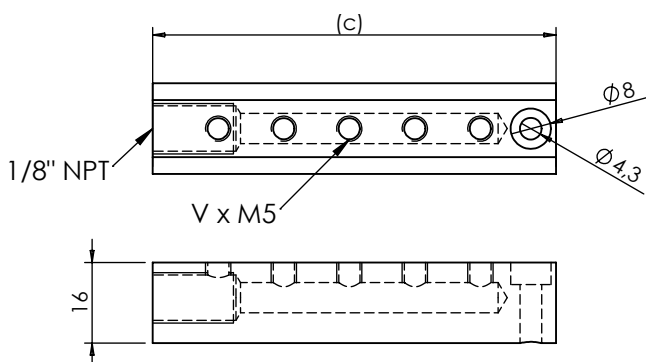

Código	C	V (saídas)
M01-03	54	03
M01-04	67	04
M01-05	80	05
M01-06	93	06
M01-07	106	07